



# FIRST FLOOR

## Concert Friday Nite

**National Store**  
101

**Champlain Mtg**  
6/20/24  
102

**Aux Nat Mtg**  
105

**LDC/SR MTG**  
6/20/24  
103

**NBOD 6/19/24**  
ABOD  
NBOD/ABOD  
8/20/24  
104

**SUITES 101-114**  
1,748-2,816 SQ. FT.

- ENTRANCES
- SUITES & MEETING ROOMS
- PUBLIC AREAS
- VENUES
- NON-PUBLIC AREAS
- RESTROOMS
- ELEVATORS
- OUTDOOR SPACE

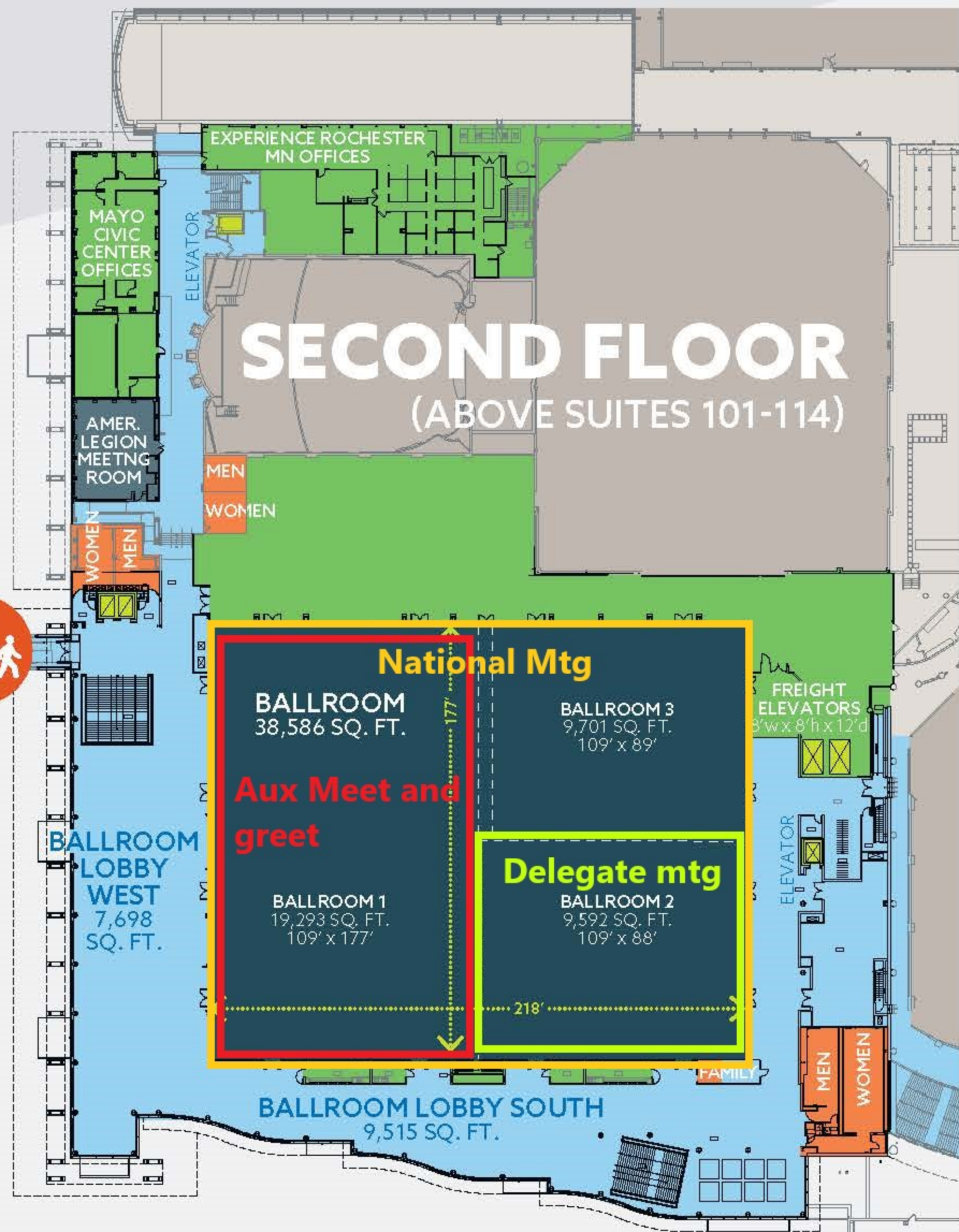
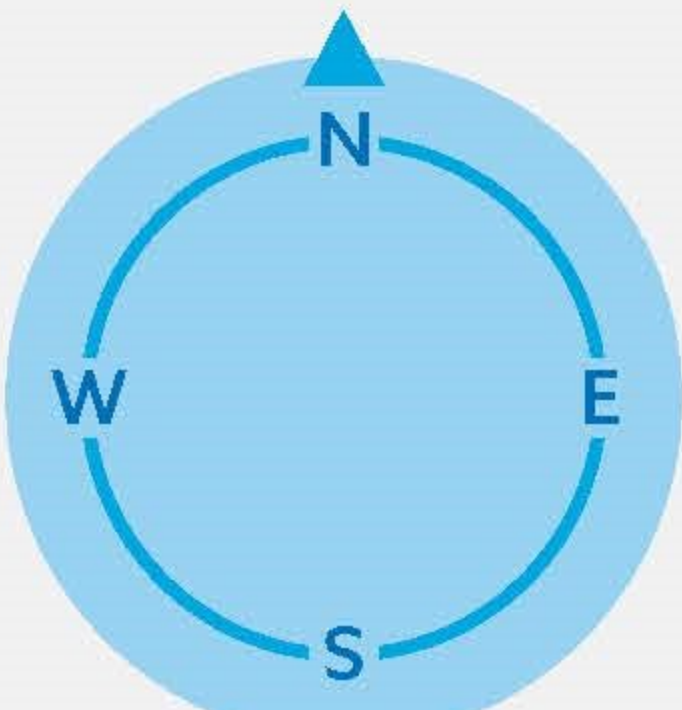

# SECOND FLOOR (ABOVE SUITES 101-114)

**National Mtg**  
BALLROOM 38,586 SQ. FT.

**Aux Meet and greet**  
BALLROOM 1 17,293 SQ. FT.  
109' x 177'

**Delegate mtg**  
BALLROOM 2 9,592 SQ. FT.  
109' x 88'



Contact the Mayo Civic Center for event services and information at **800 422 2199** or [info@mayociviccenter.com](mailto:info@mayociviccenter.com)

